**Features**

- International standard package
- Planar glass passivated chips

Typical Applications

- High power rectifiers
- Field supply for DC motors
- Power supplies

 $I_{F(AV)}$ **60A** V_{RRM} **1000V 1200V****1600V** I_{FSM} **600 A** I^2t **1800 A²s**

SYMBOL	CHARACTERISTIC	TEST CONDITIONS		T _j (°C)	VALUE			UNIT
					Min	Type	Max	
$I_{F(AV)}$	Mean forward current	180° half sine wave 50Hz Double side cooled,	T _C =100°C	175			60	A
$I_{T(RMS)}$	RMS on-state current						94	A
V_{RRM}	Repetitive peak reverse voltage	tp=10ms		175	1000		1600	V
I_{RRM}	Repetitive peak current	at V _{RRM}		175			10	mA
I_{FSM}	Surge forward current	10ms half sine wave		175			600	A
I^2t	I^2t for fusing coordination	V _R =0.6V _{RRM}					1800	A ² s
V_{FO}	Threshold voltage			175			0.85	V
r_F	Forward slope resistance						2.3	mΩ
V_{FM}	Peak forward voltage	I _{FM} =180A		175			1.30	V
$R_{th(j-c)}$	Thermal resistance Junction to case	Clamping force 2.4kN					1.08	°C /W
F_m	Mounting force					2.4	2.9	kN
T_{stg}	Stored temperature				-40		175	°C
T_{jm}	Junction temperature				-40		175	°C
W_t	Weight					15		g
Outline	ZL06/ZL06A							

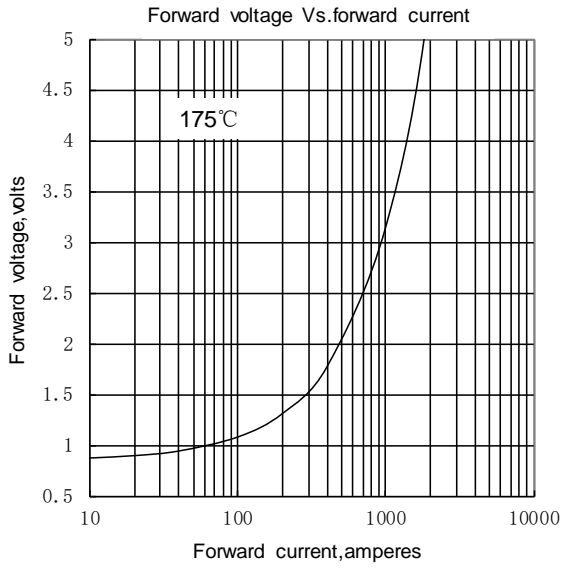

Fig.1

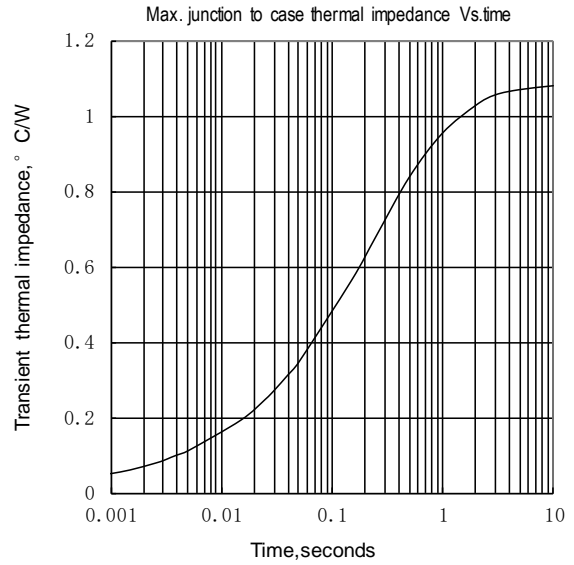

Fig.2

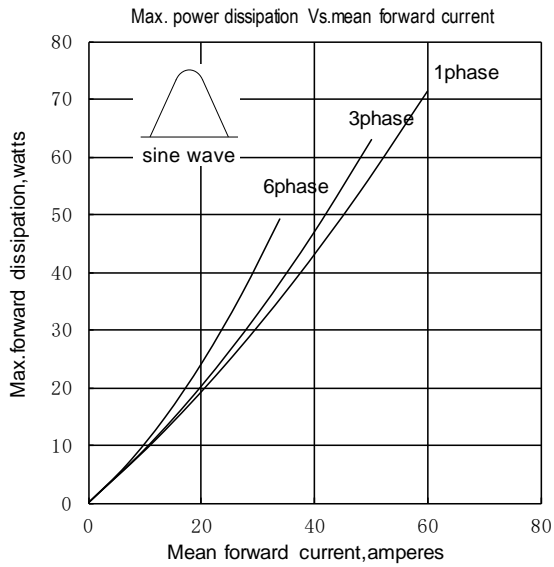

Fig.3

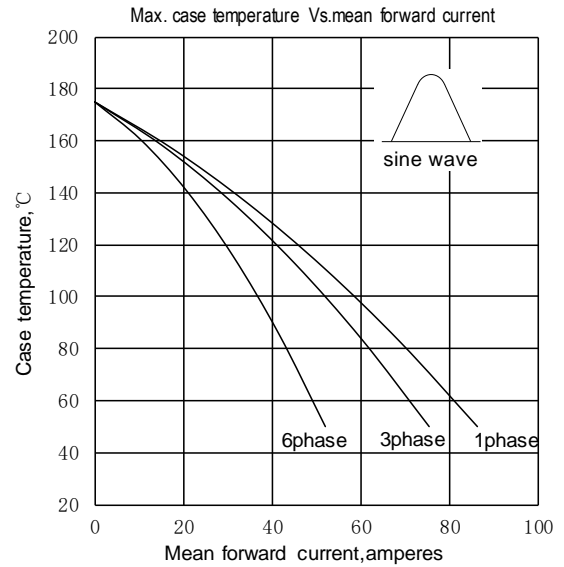

Fig.4

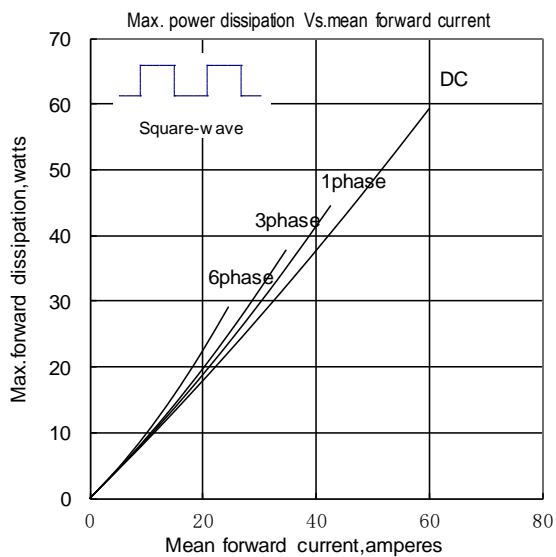

Fig.5

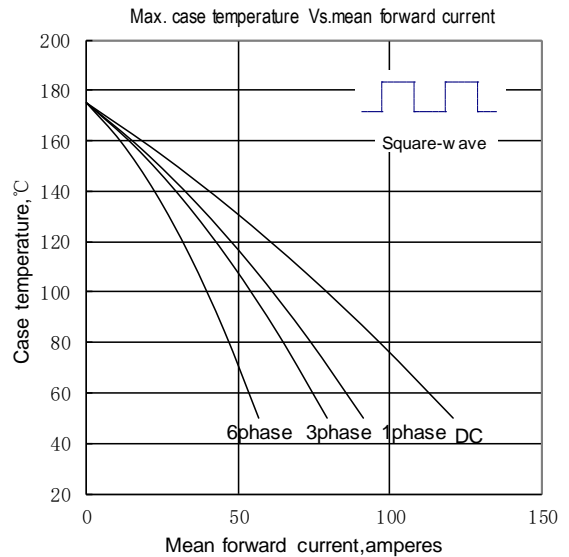

Fig.6

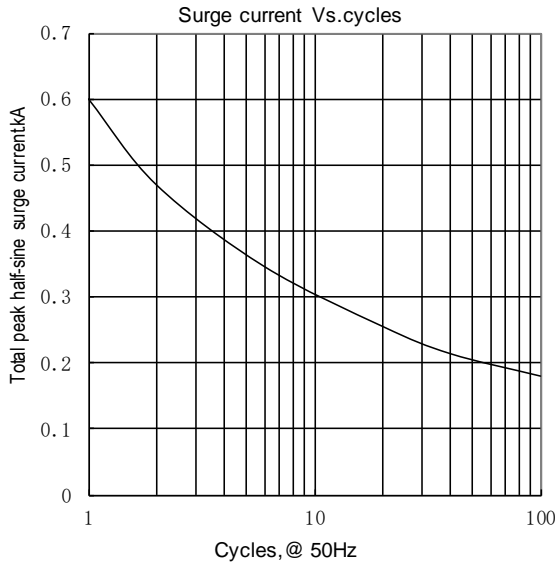

Fig.7

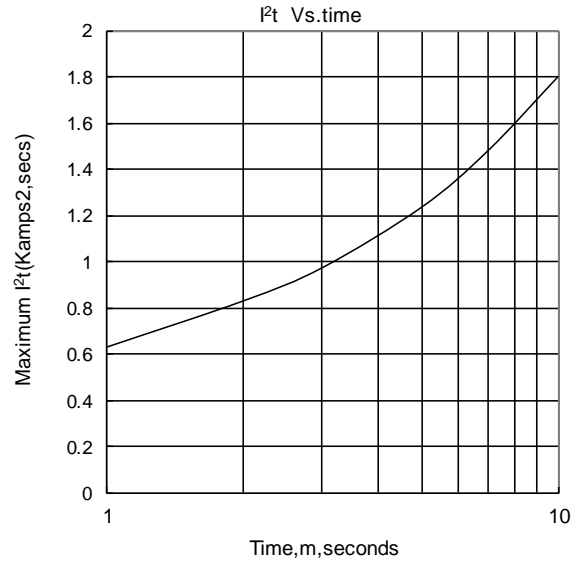
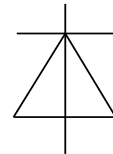
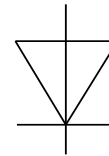
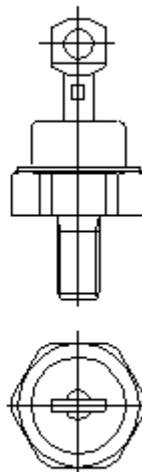
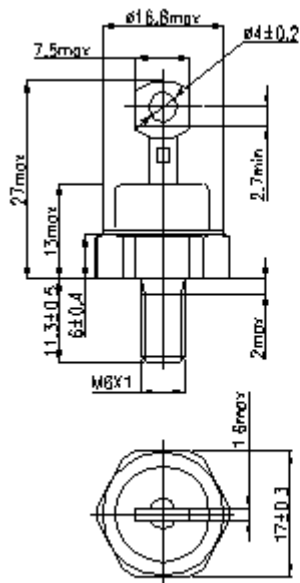

Fig.8



ZP060**ZL06

ZP060**ZL06A