

Features

- Low forward voltage drop
- High reverse voltage
- Hermetic metal cases with ceramic insulators

I_{F(AV)} 5900A
V_{RRM} 200 ~ 1000V
I_{FSM} 62 kA
I²t 19220 10³A²S

Typical Applications

- All purpose high power rectifier diodes
- High power resistance welding equipment
- Non-controllable and half-controllable rectifiers
- Controlled rectifiers

SYMBOL	CHARACTERISTIC	TEST CONDITIONS		T _j (°C)	VALUE			UNIT
					Min	Type	Max	
I _{F(AV)}	Mean forward current	180° half sine wave 50Hz Double side cooled,	T _C =85°C	190			5900	A
V _{RRM}	Repetitive peak reverse voltage	tp=10ms		190	200		1000	V
I _{RRM}	Repetitive peak current	at V _{RRM}		190			100	mA
I _{FSM}	Surge forward current	10ms half sine wave		190			62	kA
I ² t	I ² t for fusing coordination	V _R =0.6V _{RRM}						19220
V _{FO}	Threshold voltage			190			0.630	V
r _F	Forward slope resistance							0.058
V _{FM}	Peak on-state voltage	I _{FM} =5000A, F=32kN		25			1.28	V
Q _{rr}	Recovery charge	I _{FM} =2000A, tp=4000μs, di/dt=-20A/μs, V _R =100V		190		4500		μC
R _{th(j-c)}	Thermal resistance Junction to case	D.C. double side cooled Clamping force 35kN					0.012	°C/W
R _{th(c-h)}	Thermal resistance case to heat sink							
F _m	Mounting force				30		40	kN
T _{vj}	Junction temperature				-40		190	°C
T _{slg}	Stored temperature				-40		190	°C
W _t	Weight					880		g
Outline	P44							

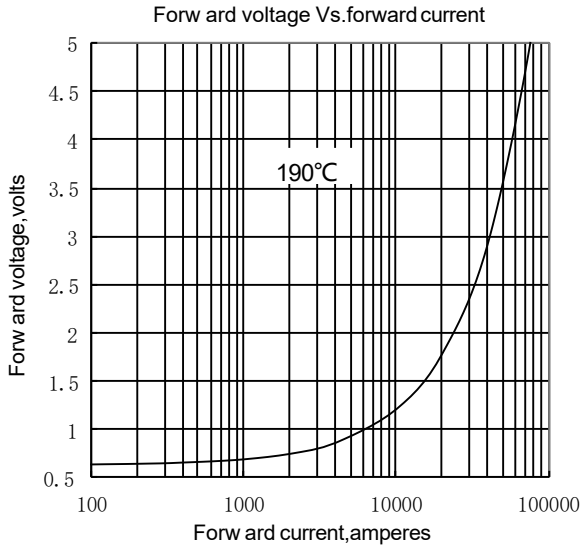

Fig.1

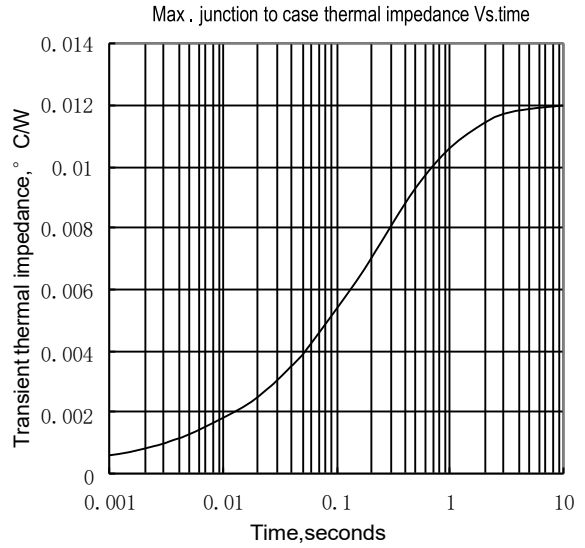

Fig.2

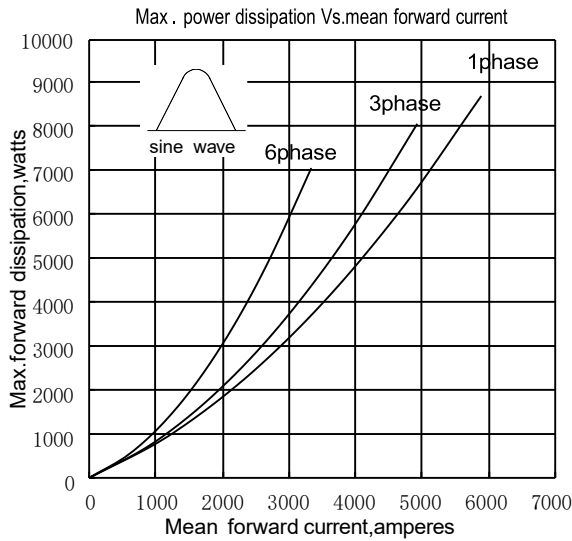

Fig.3

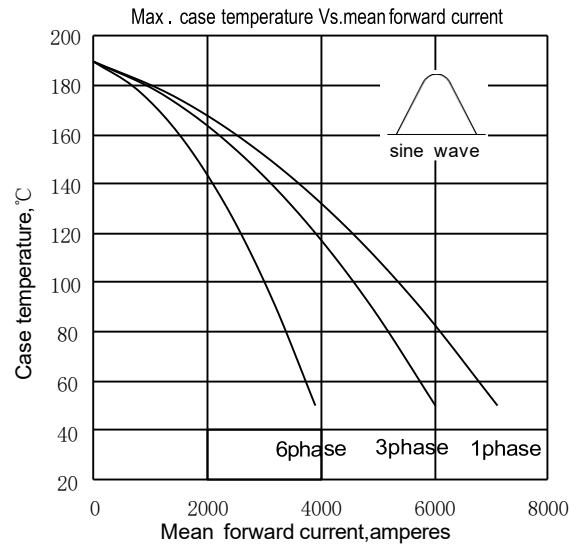

Fig.4

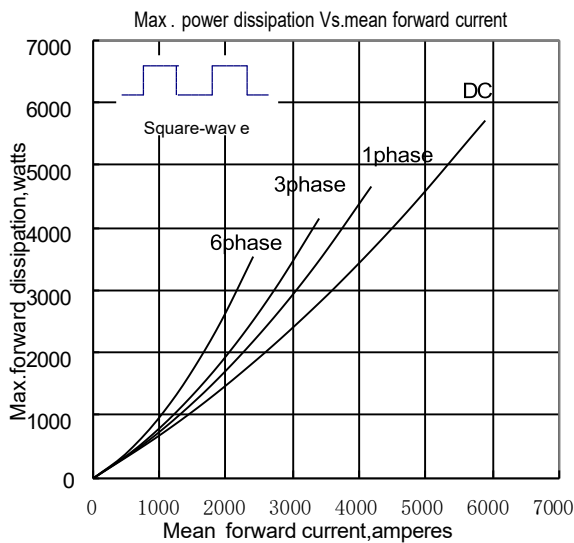

Fig.5

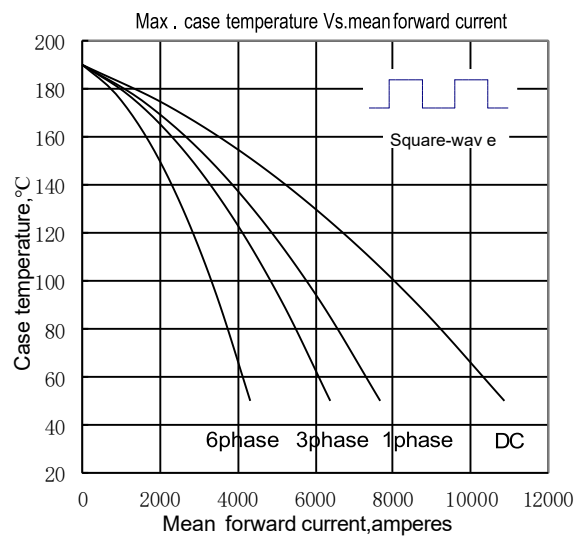

Fig.6

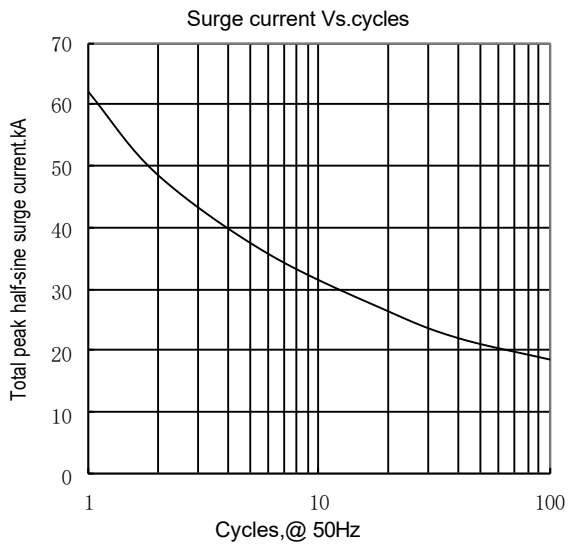
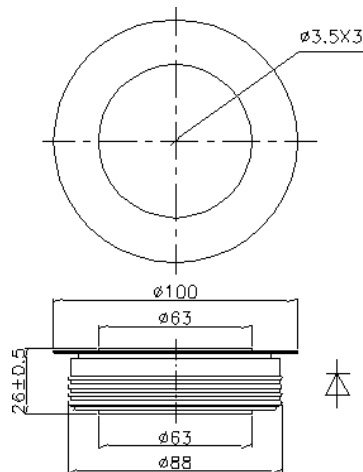

Fig.7

Outline:



Nlps reserves the right to change specifications without notice.