

Features

- Low forward voltage drop
- High reverse voltage
- Hermetic metal cases with ceramic insulators

Typical Applications

- All purpose high power rectifier diodes
- High power resistance welding equipment
- Non-controllable and half-controllable rectifiers
- Controlled rectifiers

$I_{F(AV)}$ **5250A**
 V_{RRM} **5100~6500 V**
 I_{FSM} **84 kA**
 I^2t **35280 10^4A^2S**



SYMBOL	CHARACTERISTIC	TEST CONDITIONS		T _j (°C)	VALUE			UNIT
					Min	Type	Max	
$I_{F(AV)}$	Mean forward current	180° half sine wave 50Hz Double side cooled,	T _c =100°C	150			5250	A
V_{RRM}	Repetitive peak reverse voltage	tp=10ms		150	5100		6500	V
I_{RRM}	Repetitive peak current	at V _{RRM}		150			400	mA
I_{FSM}	Surge forward current	10ms half sine wave		150			84	kA
I^2t	I ² t for fusing coordination	V _R =0.6V _{RRM}					35280	A ² s*10 ⁴
V_{FO}	Threshold voltage			150			0.81	V
r_F	Forward slope resistance						0.12	mΩ
V_{FM}	Peak forward voltage	I _{FM} =5000A, F=140kN		150			1.65	V
Q_{rr}	Recovery charge	I _{FM} =2000A, tp=2000μs, di/dt= -20A/μs, V _R =50V		150		20000		μC
$R_{th(j-c)}$	Thermal resistance Junction to case	DC: double side cooled Clamping force140kN					0.004	°C /W
$R_{th(c-h)}$	Thermal resistance case to heat sink						0.001	
F_m	Mounting force				110		140	kN
T_{stg}	Stored temperature				-40		160	°C
W_t	Weight					3420		g
Outline	P55							

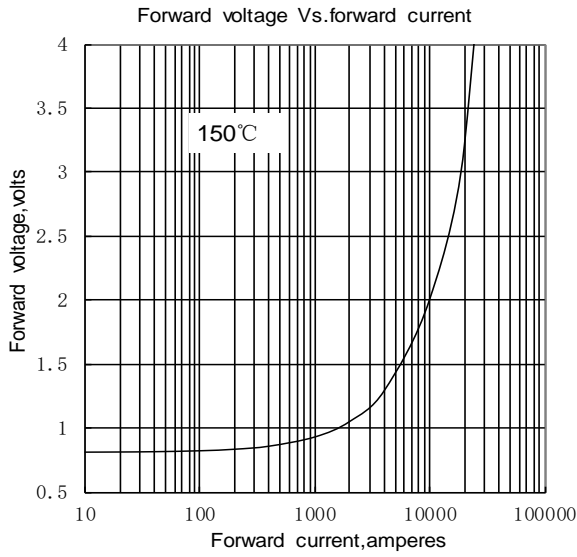

Fig.1

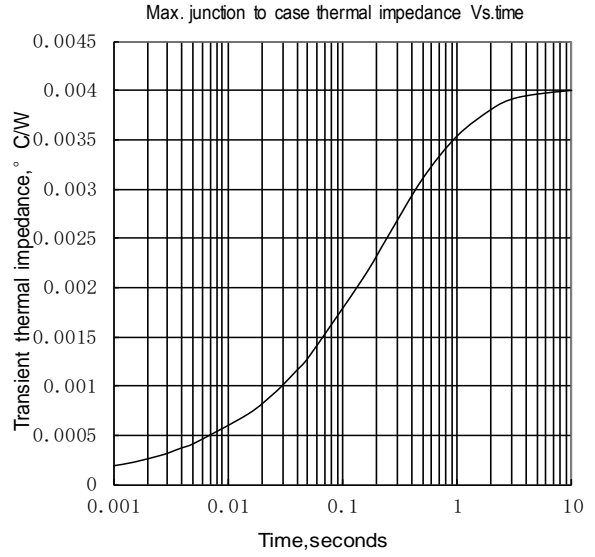

Fig.2

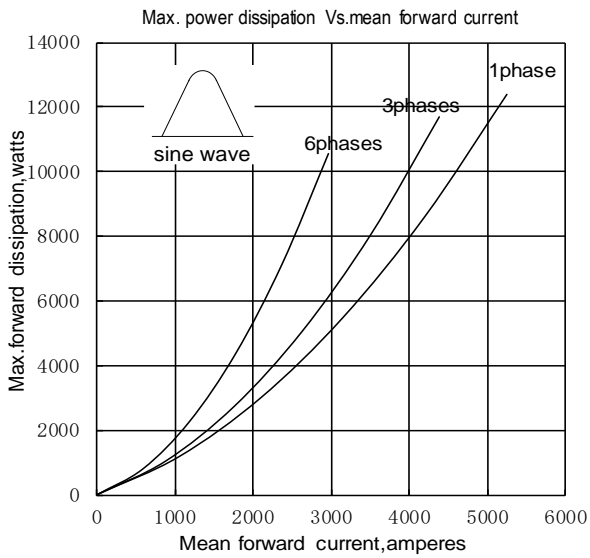

Fig.3

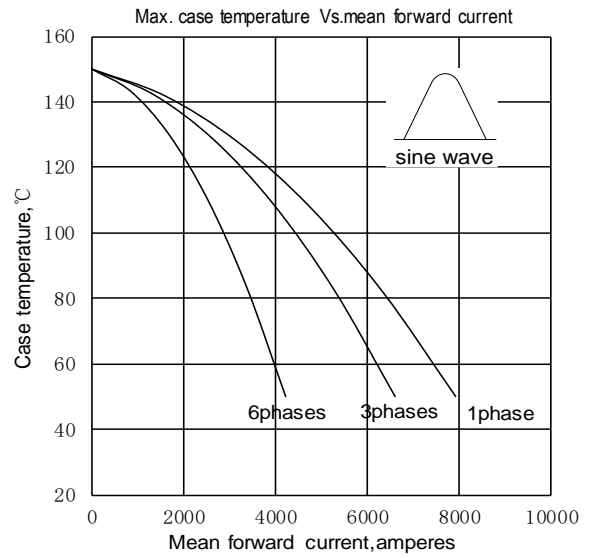

Fig.4

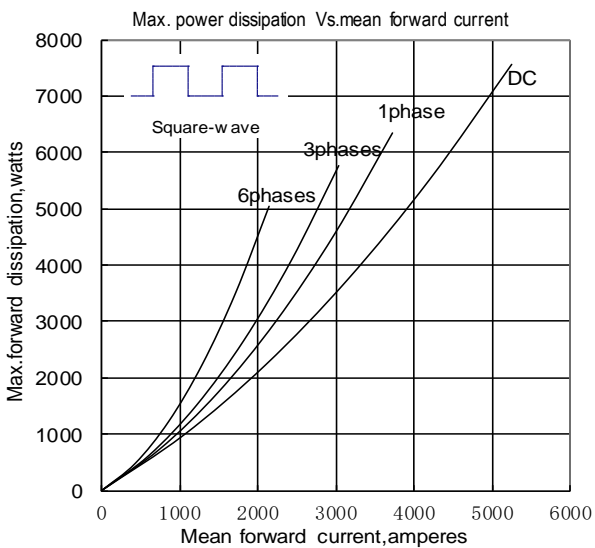

Fig.5

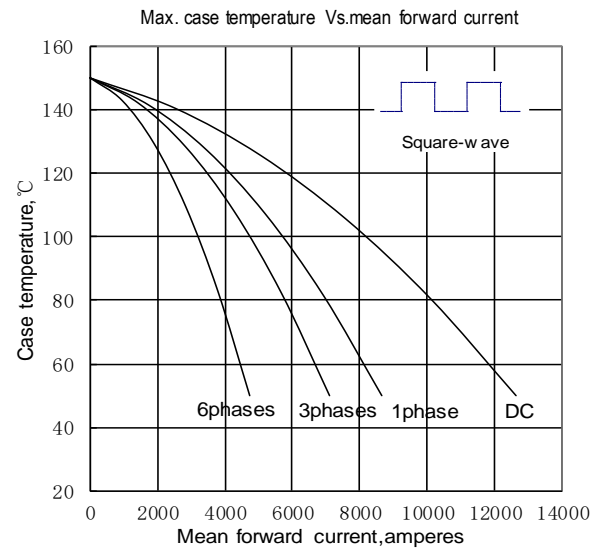

Fig.6

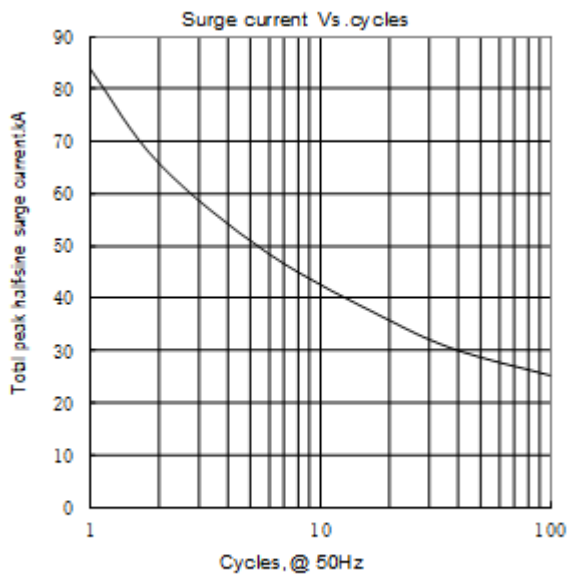
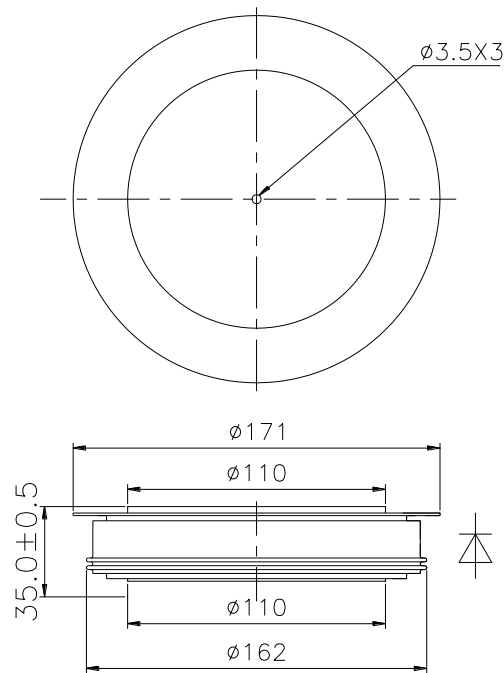

Fig.7



Nlps reserves the right to change specifications without notice.