

Features

- Low forward voltage drop
- High reverse voltage
- Hermetic metal cases with ceramic insulators

Typical Applications

- All purpose high power rectifier diodes
- High power resistance welding equipment
- Non-controllable and half-controllable rectifiers
- Controlled rectifiers

$I_{F(AV)}$ **3470 A**
 V_{RRM} **2100~3000 V**
 I_{FSM} **35 kA**
 I^2t **6125 10³A²S**



SYMBOL	CHARACTERISTIC	TEST CONDITIONS	T _j (°C)	VALUE			UNIT
				Min	Type	Max	
I _{F(AV)}	Mean forward current	180° half sine wave 50Hz Double side cooled, T _C =85°C	160			3470	A
V _{RRM}	Repetitive peak reverse voltage	tp=10ms	160	2100		3000	V
I _{RRM}	Repetitive peak current	At V _{RRM}	160			160	mA
I _{FSM}	Surge forward current	10ms half sine wave V _R =0.6V _{RRM}	160			35	kA
I ² t	I ² t for fusing coordination					6125	A ² s*10 ³
V _{FO}	Threshold voltage		160			0.95	V
r _F	Forward slope resistance					0.10	mΩ
V _{FM}	Peak forward voltage	I _{FM} =5000A, F=40kN	160			1.45	V
Q _{rr}	Recovery charge	I _{FM} =2000A, tp=2000μs, di/dt=-20A/μs, V _R =50V	160		5500		μC
R _{th(j-c)}	Thermal resistance Junction to case	DC: double side cooled Clamping force 40kN				0.012	°C /W
R _{th(c-h)}	Thermal resistance case to heat sink					0.003	
F _m	Mounting force			30		40	kN
T _{stg}	Stored temperature			-40		160	°C
W _t	Weight				880		g
Outline	P44						

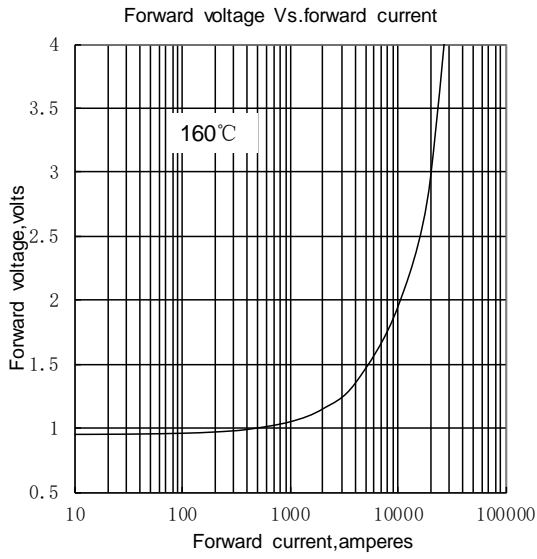

Fig.1

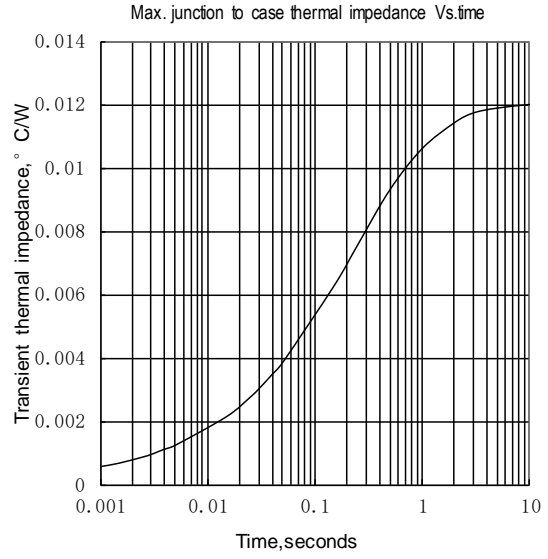

Fig.2

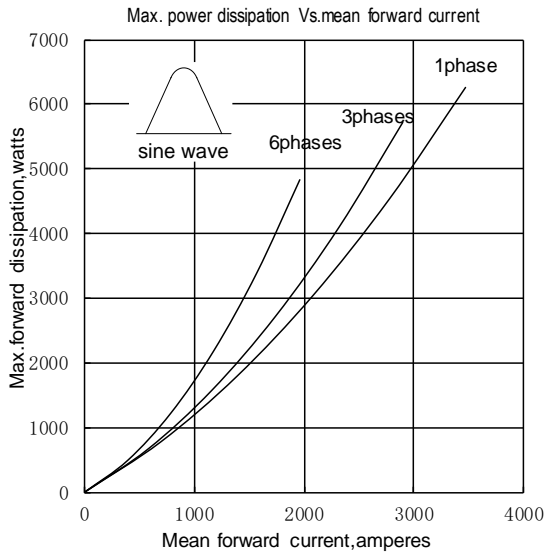

Fig.3

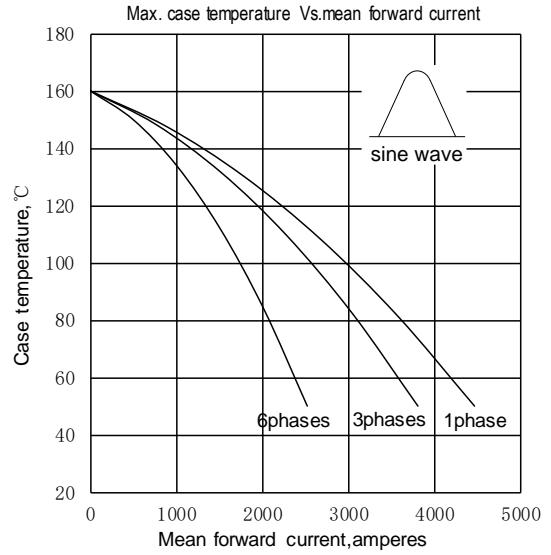

Fig.4

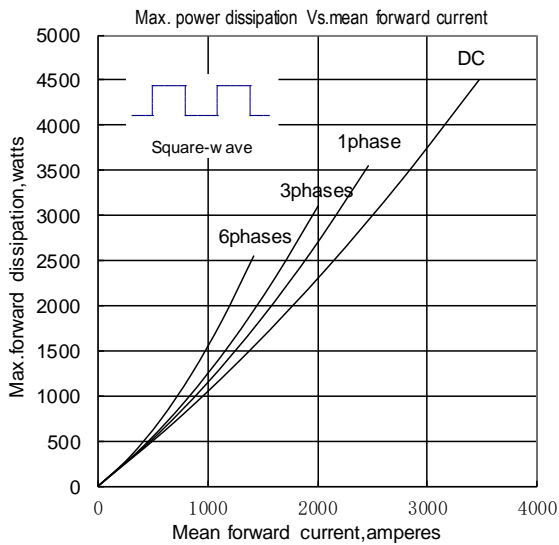

Fig.5

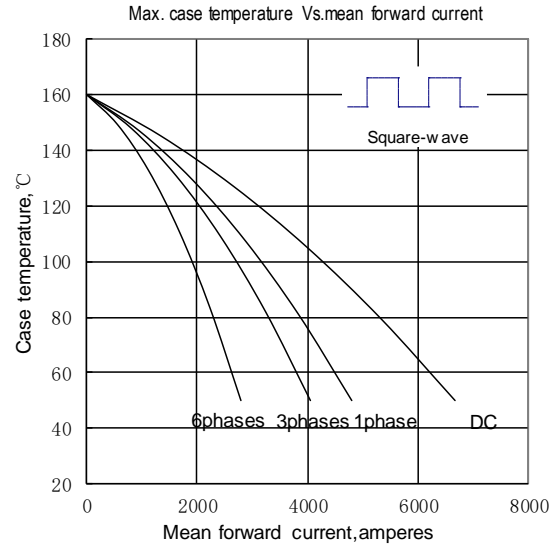

Fig.6

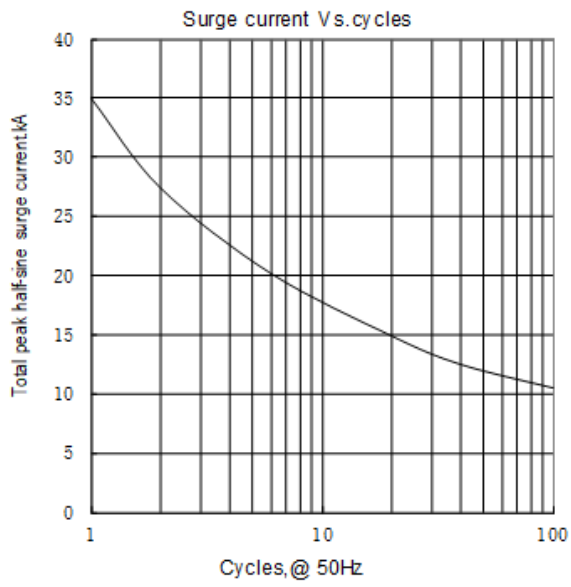
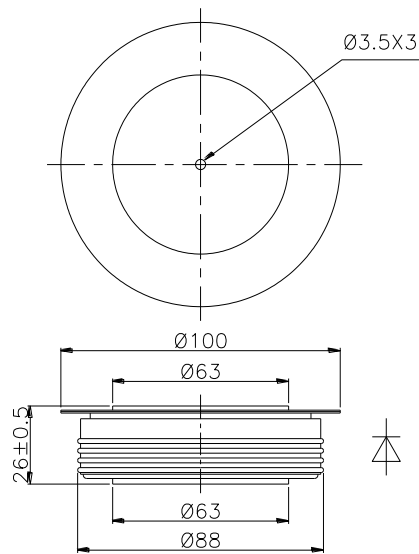

Fig.7



Nlps reserves the right to change specifications without notice.