

Features :

- Isolated mounting base 4000V~
- Pressure contact technology with Increased power cycling capability
- Space and weight saving

Typical Applications

- AC/DC Motor drives
- Various rectifiers
- DC supply for PWM inverter

V _{RSM}	V _{RRM}	品名
2700V	2600V	Mx400D260W
2900V	2800V	Mx400D280W
3100V	3000V	Mx400D300W
3300V	3200V	Mx400D320W
3500V	3400V	Mx400D340W
3700V	3600V	Mx400D360W

SYMBOL	CHARACTERISTIC	TEST CONDITIONS	T _j (°C)	VALUE			UNIT
				Min.	Typ.	Max.	
I _{F(AV)}	Mean forward current	180° half sine wave 50Hz Single side water cooled, T _c =60°C	150			400	A
I _{F(RMS)}	RMS forward current		150			628	A
I _{RRM}	Repetitive peak current	at V _{RRM}	150			35	mA
I _{FSM}	Surge forward current	10ms half sine wave V _R =0.6V _{RRM}	150			8.1	kA
I ² t	I ² t for fusing coordination					328	A ² s*10 ³
V _{FO}	Threshold voltage		150			0.95	V
r _F	Forward slope resistance					1.05	mΩ
V _{FM}	Peak forward voltage	I _{FM} =1200A	25			2.41	V
R _{th(j-c)}	Thermal resistance Junction to case	D.C. Single side cooled per chip				0.11	°C/W
R _{th(c-h)}	Thermal resistance case to heat sink	DC. Single side cooled per chip				0.04	°C/W
V _{iso}	Isolation voltage	50Hz,R.M.S,t=1min, I _{iso} :1mA(max)		4000			V
F _m	Terminal connection torque(M10)				12.0		N·m
	Mounting torque(M6)				6.0		N·m
T _{stg}	Stored temperature			-40		125	°C
W _t	Weight				1560		g
Outline	M14						

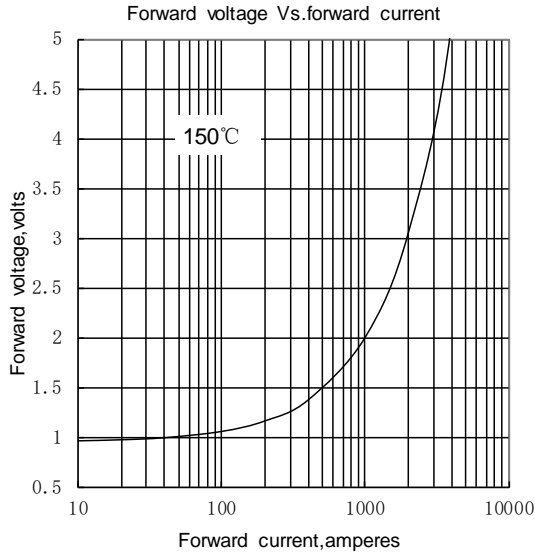

Fig.1

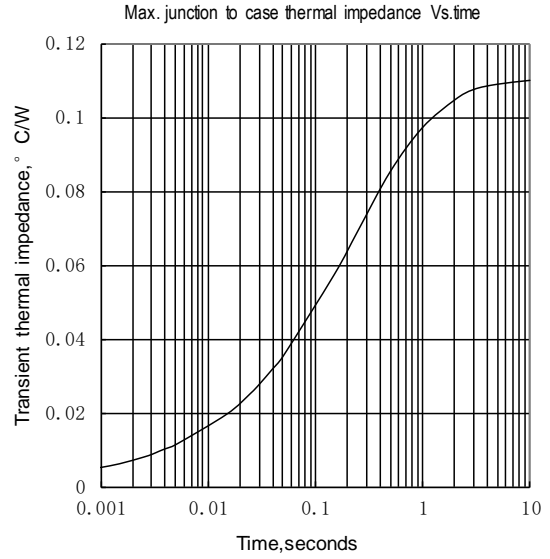

Fig.2

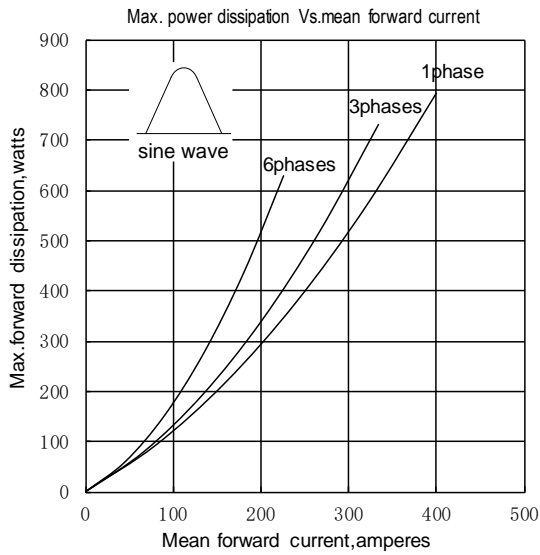

Fig.3

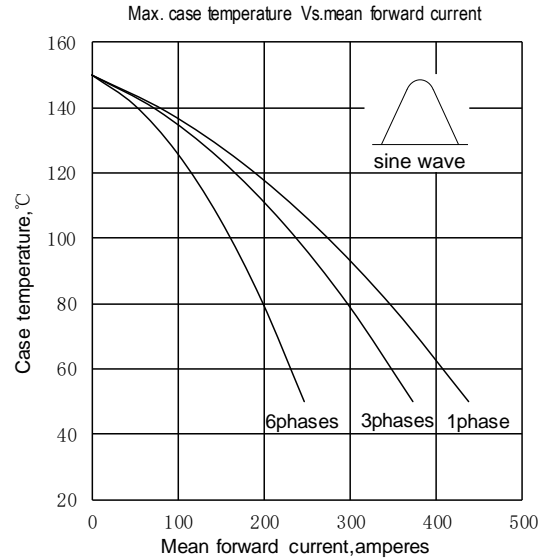

Fig.4

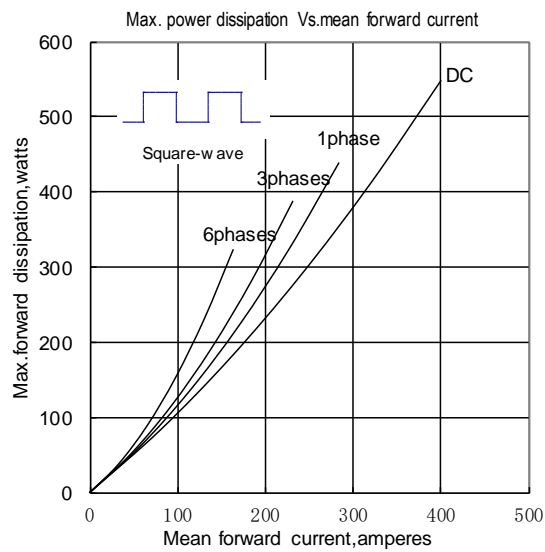

Fig.5

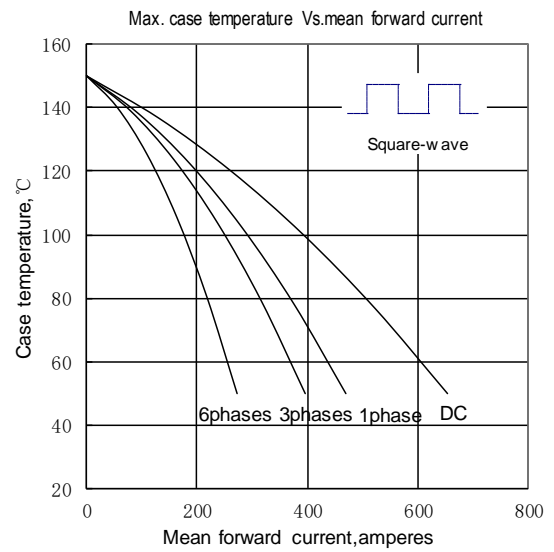

Fig.6

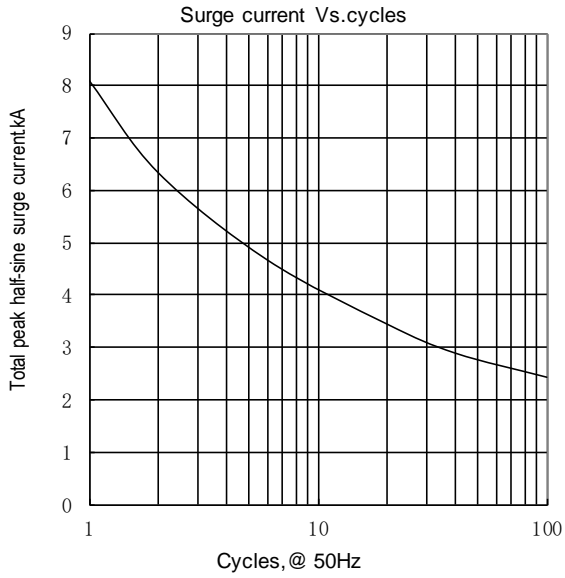
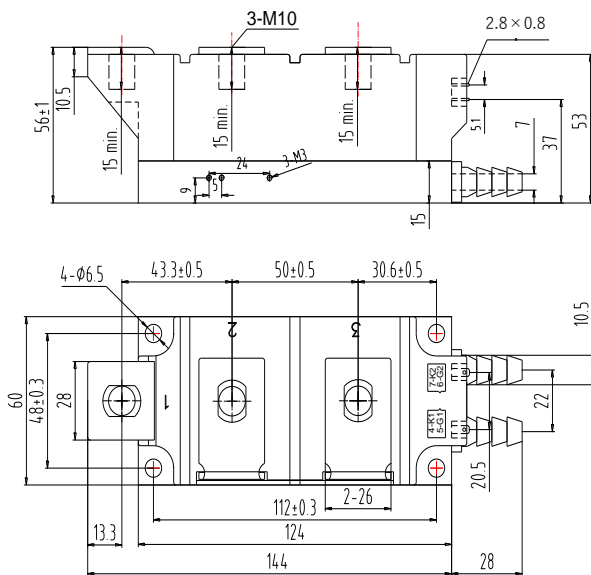

Fig.7



Unmarked dimensional tolerance : ±0.5mm

MD400D**W

MR400D**W

MC400D**W

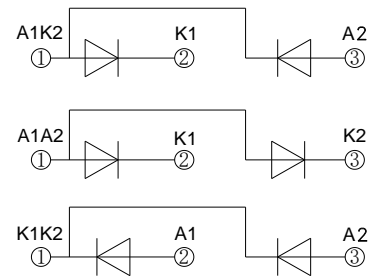

Nlps reserves the right to change specifications without notice.