

Features :

- Isolated mounting base 3000V~
- Solder joint technology with increased power cycling capability
- Space and weight saving

Typical Applications :

- Various rectifiers
- DC supply for PWM inverter

V _{RSM}	V _{RRM}	品名
700V	600V	MD55D60S
900V	800V	MD55D80S
1100V	1000V	MD55D100S
1300V	1200V	MD55D120S
1500V	1400V	MD55D140S
1700V	1600V	MD55D160S
1900V	1800V	MD55D180S

SYMBOL	CHARACTERISTIC	TEST CONDITIONS	T _j (°C)	VALUE			UNIT
				Min	Type	Max	
I _{F(AV)}	Mean forward current	180° half sine wave 50Hz Single side cooled, T _c =100°C	150			55	A
I _{F(RMS)}	RMS forward current		150			86	A
I _{RRM}	Repetitive peak current	at V _{RRM}	150			8	mA
I _{FSM}	Surge forward current	10ms half sine wave V _R =0.6V _{RRM}	150			1.8	kA
I ² t	I ² t for fusing coordination					16.2	10 ³ A ² s
V _{FO}	Threshold voltage		150			0.80	V
r _F	Forward slope resistance					3.74	mΩ
V _{FM}	Peak forward voltage	I _{FM} =170A	25			1.40	V
R _{th(j-c)}	Thermal resistance Junction to case	D.C. Single side cooled per chip				0.70	°C/W
R _{th(c-h)}	Thermal resistance case to heatsink	D.C. Single side cooled per chip				0.20	°C/W
V _{iso}	Isolation voltage	50Hz, R.M.S., t=1min, I _{iso} :1mA(max)		3000			V
F _m	Terminal connection torque(M5)			2.4		3.0	N·m
	Mounting torque(M6)			3.5		5.0	N·m
T _{vj}	Junction temperature			-40		150	°C
T _{stg}	Stored temperature			-40		125	°C
W _t	Weight				100		g
Outline	M16						

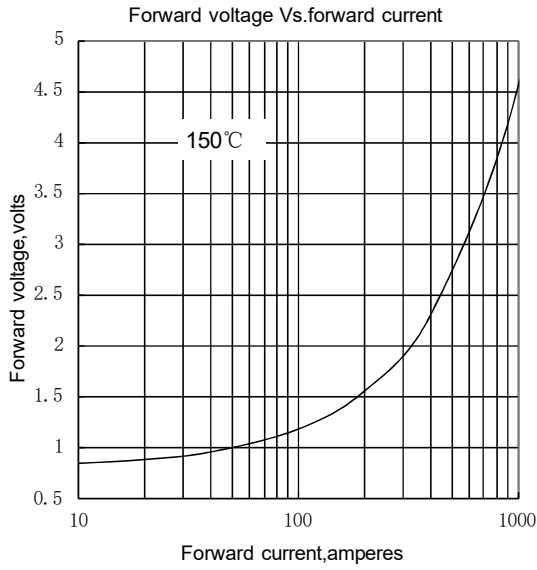

Fig.1

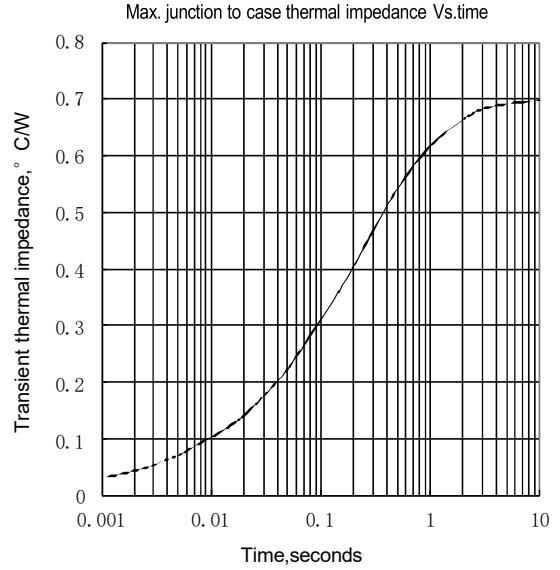

Fig.2

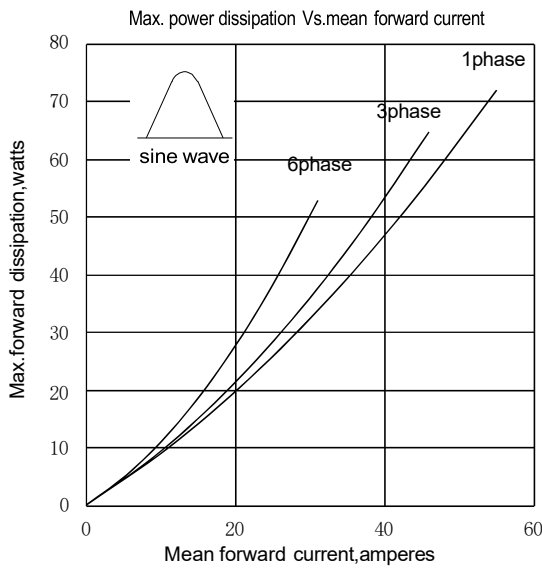

Fig.3

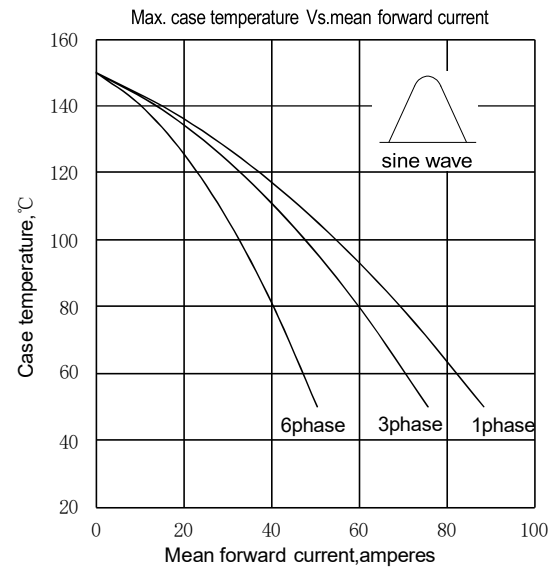

Fig.4

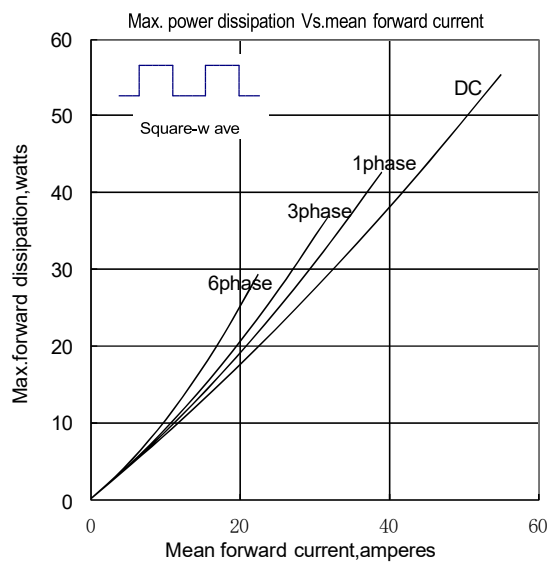

Fig.5

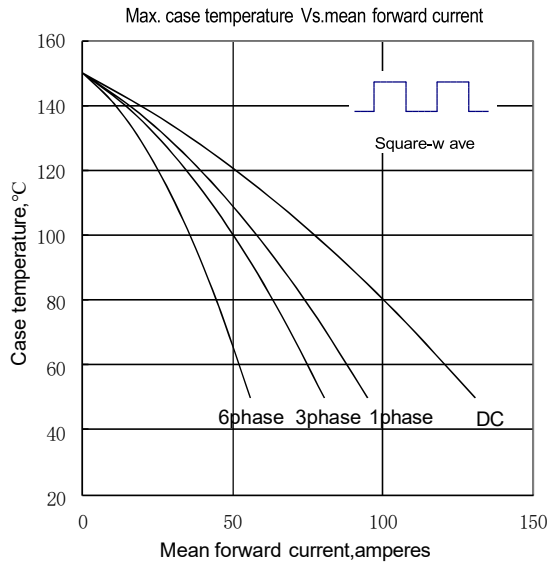

Fig.6

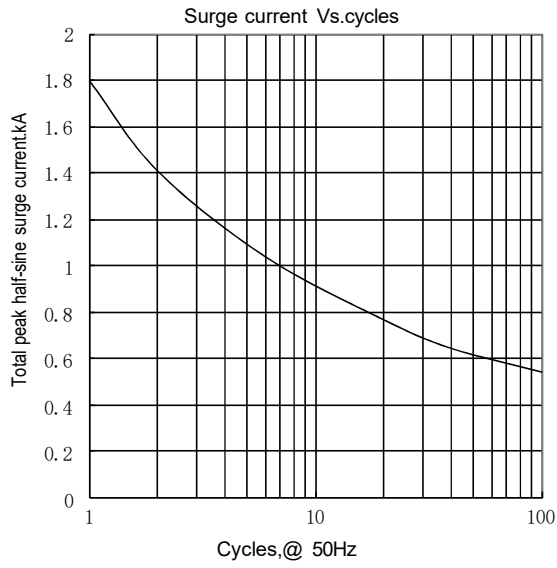
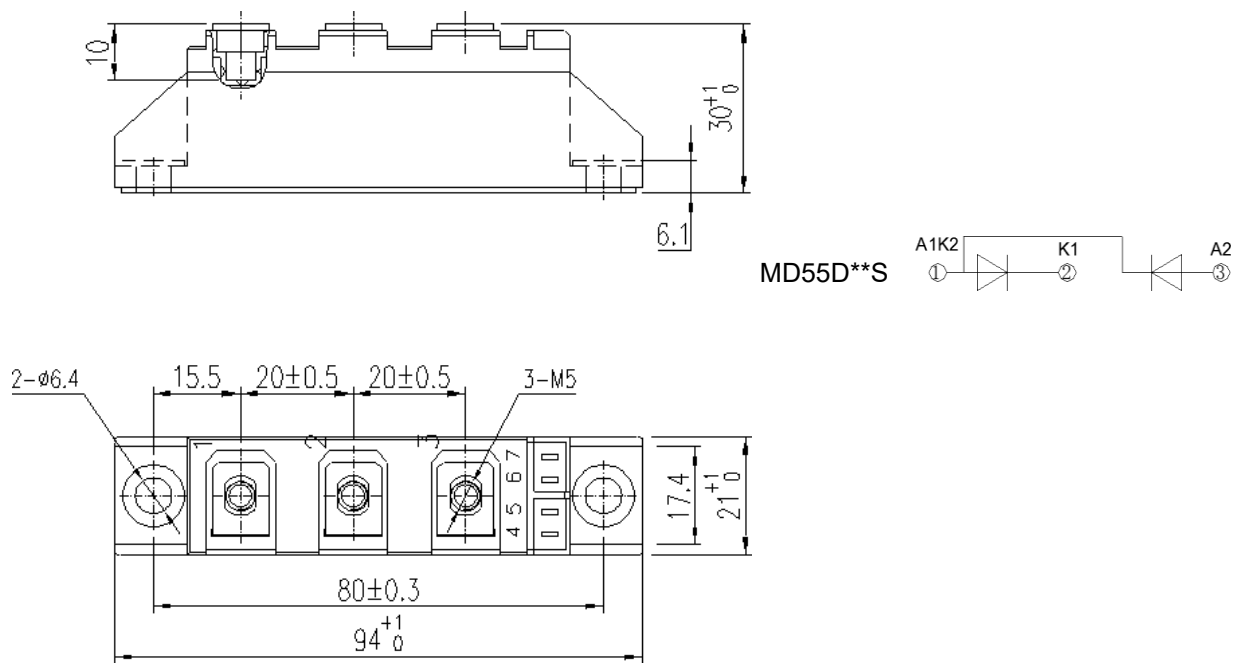

Fig.7

Outline:



Unmarked dimensional tolerance: ±0.5mm