

Features

- International standard package
- Planar glassivated chips

Typical Applications

- High power rectifiers
- Field supply for DC motors
- Power supplies

$I_{F(AV)}$	60A
V_{RRM}	1000~1600V
I_{FSM}	600 A
I^2t	1800 A²s



SYMBOL	CHARACTERISTIC	TEST CONDITIONS	T _j (°C)	VALUE			UNIT
				Min	Type	Max	
$I_{F(AV)}$	Mean forward current	180° half sine wave 50Hz Double side cooled, T _C =100°C	175			60	A
$I_{T(RMS)}$	RMS on-state current					94	A
V_{RRM}	Repetitive peak reverse voltage	tp=10ms	175	1000		1600	V
I_{RRM}	Repetitive peak current	at V _{RRM}	175			10	mA
I_{FSM}	Surge forward current	10ms half sine wave V _R =0.6V _{RRM}	175			600	A
I^2t	I ² t for fusing coordination					1800	A ² s
V_{FO}	Threshold voltage		175			0.85	V
r _F	Forward slope resistance						2.3
V_{FM}	Peak forward voltage	I _{FM} =180A	175			1.30	V
R _{th(j-c)}	Thermal resistance Junction to case	At 180° sine double side cooled Clamping force 2.4kN				1.08	°C /W
F _m	Mounting force				2.4	2.9	kN
T _{stg}	Stored temperature			-40		175	°C
T _{jm}	Junction temperature			-40		175	°C
W _t	Weight				15		g
Outline							

Outline:

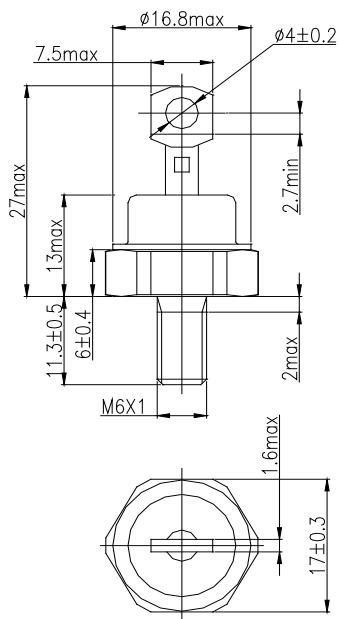

SH60D***SK

SH60D***SA

